

## INSTRUCTIONS FOR USE

### OPEN

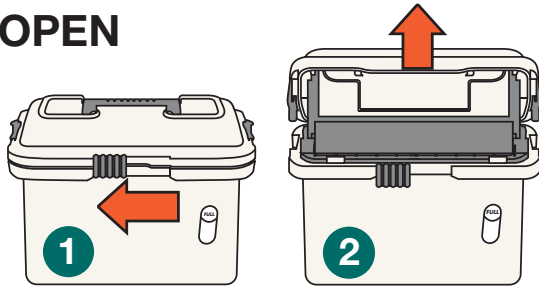

1. Slide front lock to left.

2. Lift lid until locked open.

### SYRINGES

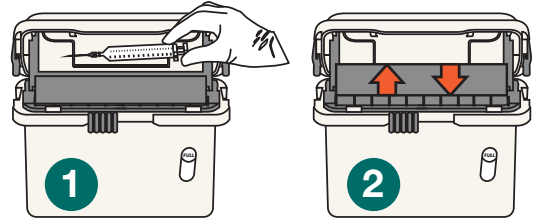

1. Drop syringe horizontally onto tray.

2. Tray will empty itself.

### LIGHT SHARPS

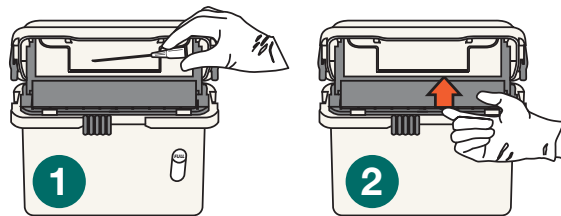

1. Drop sharp horizontally onto tray.

2. Manually lift tray to empty.

### FULL

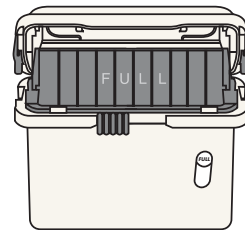

When tray remains vertical, lock and replace collector.

### CLOSE



1. Press both side supports inward, close lid.

2. Slide front lock fully to right.

### LOCK

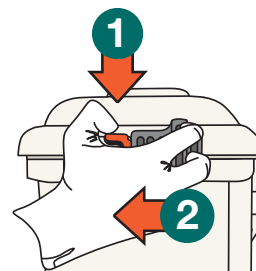

1. Depress red tabs.  
2. Slide locks completely forward.

**NOTE: Side locks are permanent!**

### REMEMBER:

- ALWAYS ENSURE SHARP HAS EMPTIED FROM TRAY • NEVER PUT HANDS BEYOND TRAY LIP
- ALWAYS CLOSE COLLECTOR BEFORE MOVING/REMOVING COLLECTOR
- DO NOT DEFACE OR WRITE ON COLLECTOR
- ALWAYS DISPOSE OF SHARPS AND SHARPS SAFETY DEVICES INTO SHARPS COLLECTORS